

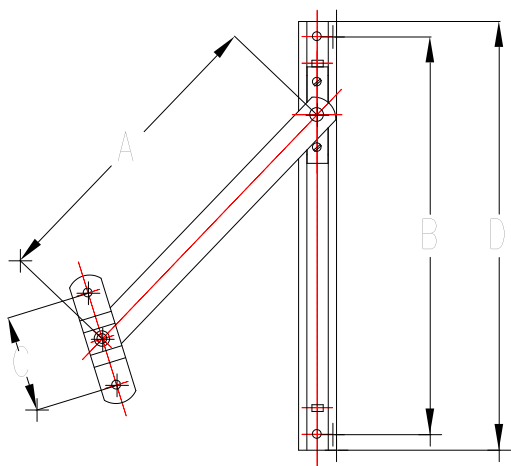

FA102 / HD102 FRICTION ARM

On side-hung windows supported by standard butt hinges (and in some cases friction stays) the friction arm offers distinct advantages over the conventional peg stay. It is totally concealed when the vent is closed and offers no internal obstruction when opened.

For large top hung vents the friction arm can be used as an extra support by fitting it below the existing friction stay. This has the effect of limiting the opening as well as adding greater stability to the window. Available in standard form at 180mm long the friction arm can also be supplied in different sizes to suit customers' specific requirements. Details available on request.



SIZES AVAILABLE	FA-10"	FA-14"	FA-18"	FA-20"	HD-10"
'A' Ref	180.09	266.95	368.05	420.12	214.0
'B' Ref	249.28	339.95	439.93	493.01	242.0
'C' Ref	57.2	57.2	57.2	57.2	56.0
'D' Ref	268.34	355.81	457.2	508.0	260.0

IT IS THE RESPONSIBILITY OF THE WINDOW MANUFACTURER TO ENSURE THAT THE FINISHED WINDOW MEET ANY REQUIRED SAFETY AND PERFORMANCE SPECIFICATIONS